

1

Main Op Station Box

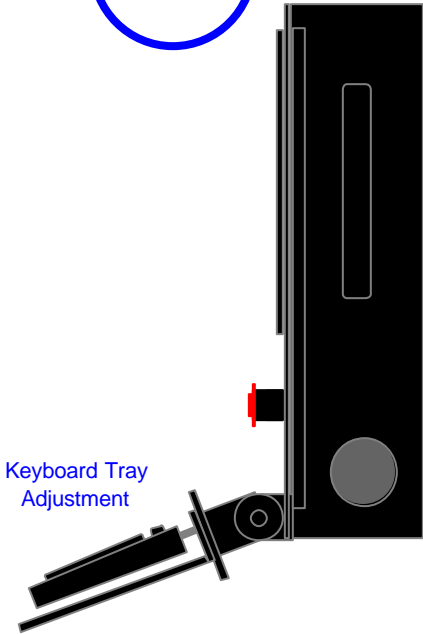

2

180deg horiz swivel joint extension & sys 80 tubing adapter

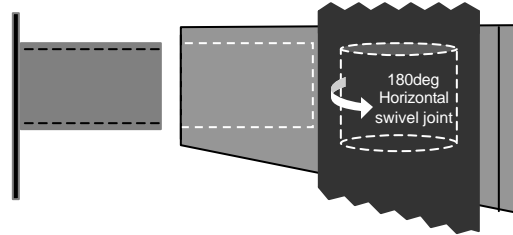

3

Fanuc 18 adapter plate



Fits right into any standard Fanuc hole. Easy to use on machines that may have previously been designed around Fanuc control mounting specs.

4

Siemens 840 adapter plate

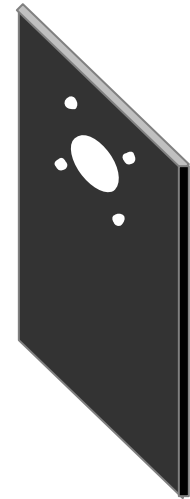

Fits right into any standard Siemens hole. Easy to use on machines that may have previously been designed around Siemens control mounting specs.

Mounting Combinations:

| | |
|-------|--|
| ① | Operator Station box alone, mounted flush against machine side wall or electrical cabinet. |
| ①+② | Box with swivel extension, mounted against machine side wall or electrical cabinet. Can also be used to connect up to ANY other sytem 80 tubing harware by any other vendor. |
| ①+②+③ | Box with swivel extension, mounted into Fanuc hole. |
| ①+②+④ | Box with swivel extension, mounted into Siemens hole. |
| ①+③ | Box alone mounted flush into Fanuc hole. |
| ①+④ | Box alone mounted flush into Siemens hole. |

1A-OCOS Operator Station